

Making a Model Airplane Stand

A great deal of hard work which goes into creating a model. But an equally important aspect is the stand to display it. Stands tend to be personalized and should be appropriate for the scale of the model.

Typically the models which I carve are 1/32" scale resulting in overall dimensions of 12" – 15" in length and 14" – 20" in width. I've put together some full size template examples for 3 stands and two bases which can be interchanged to create 6 different combinations.

The stand below was made using a bandsaw for cutting, a router to round the corners and a belt sander to finish the edges. However, all shapes can be made with basic hand tools (a plain saw for cutting the base, a coping saw for cutting the stand, a sharp chisel for cutting the bevel, a file for rounding the edges and sanding paper). The stand is attached to the base using two screws.

Before painting the model consider how the model is to be attached to the stand. Some modellers use a square piece of brass tubing or wood. Others use two dowels as shown in the picture below. The key is to provide a geometry which does not allow the model to rotate on the stand. If using two dowels as illustrated below, create a metal template for drilling the holes in the stand and the model to ensure correct alignment.

Depending on the wood used, the stands can be painted, stained or coated with a clear finish. If the wood is to be stained, don't forget to apply a sealer to even out the absorption by the end grain in the base.

Hopefully these templates will spark some ideas of your own or feel free to use them as is or scale accordingly.



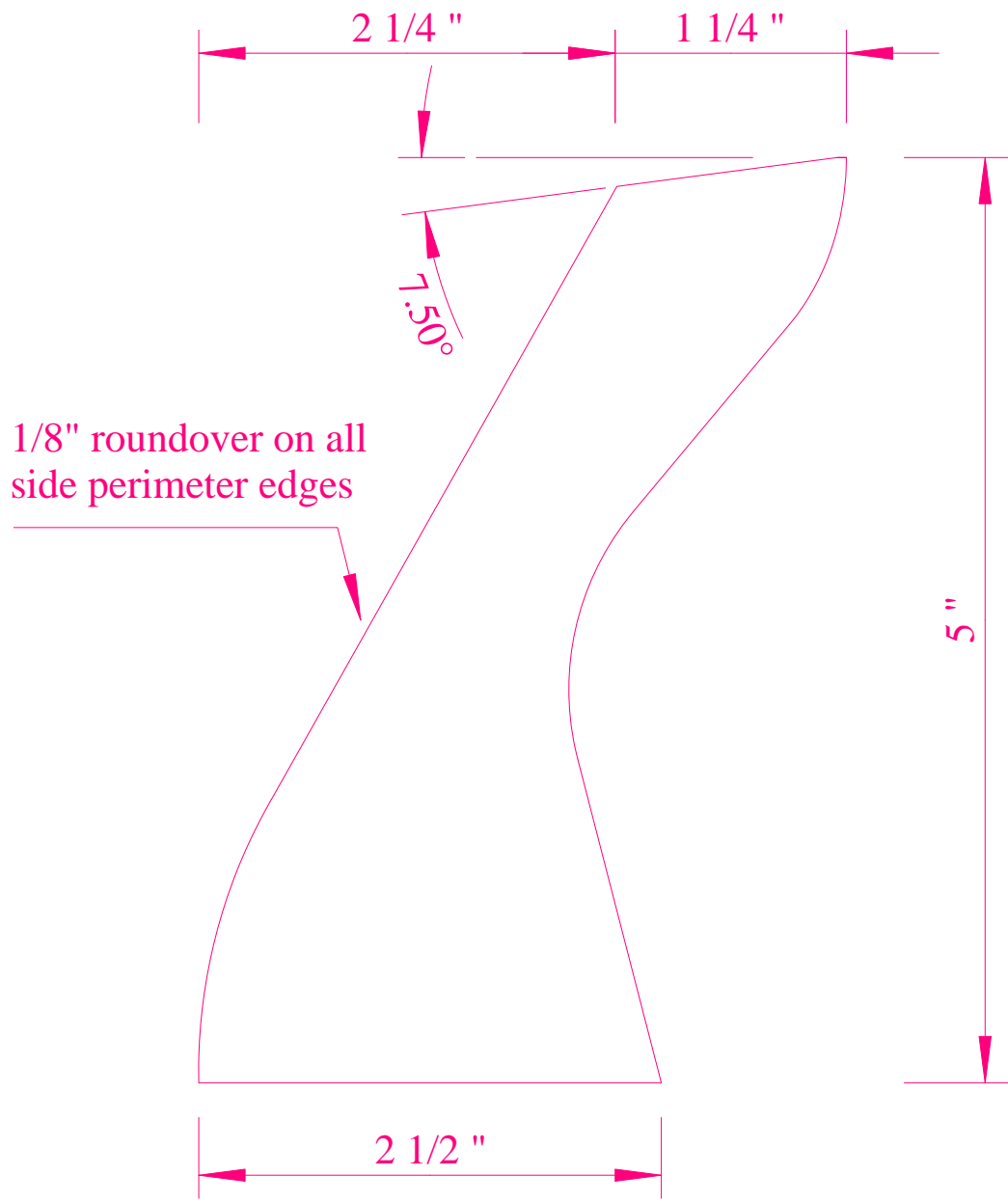

Stand 1

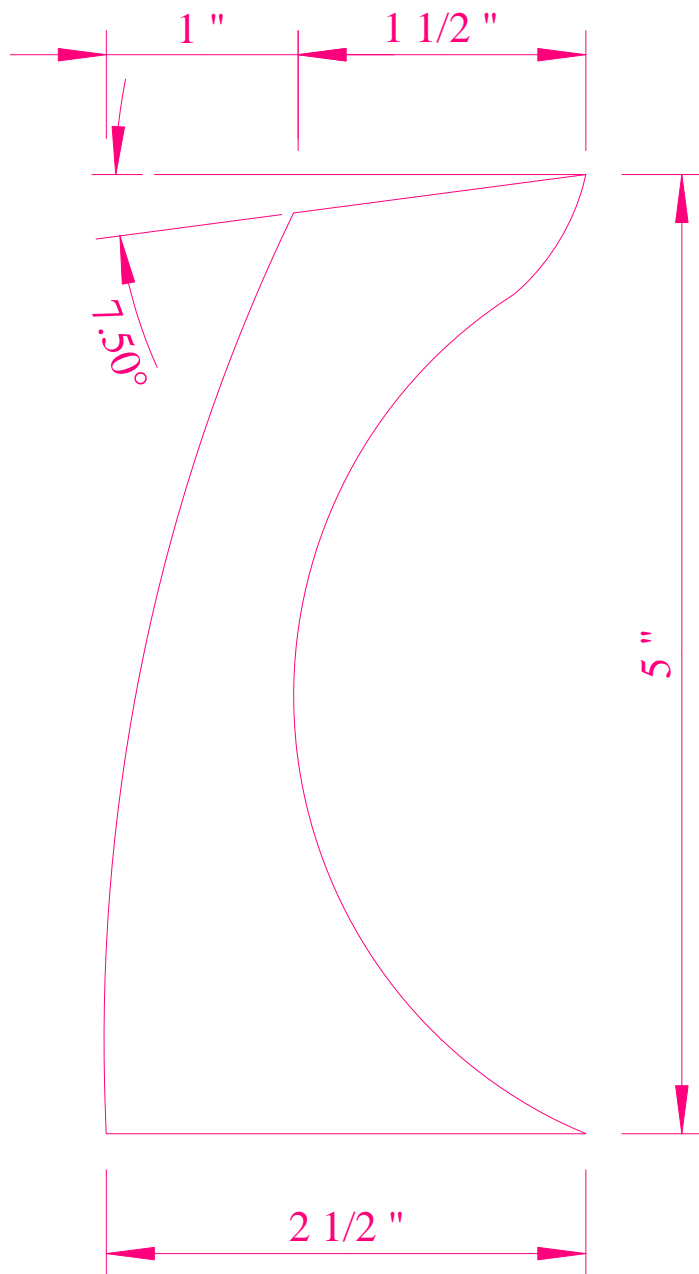

Stand 2

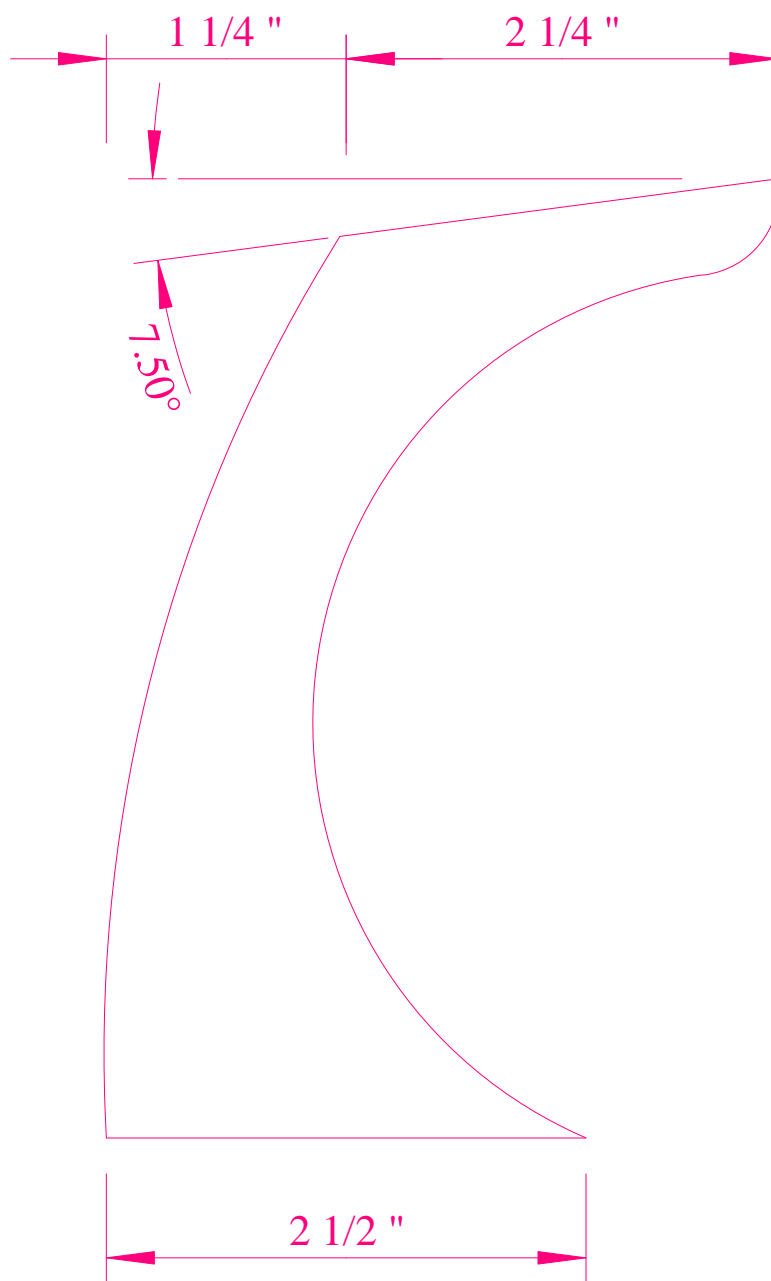

Stand 3

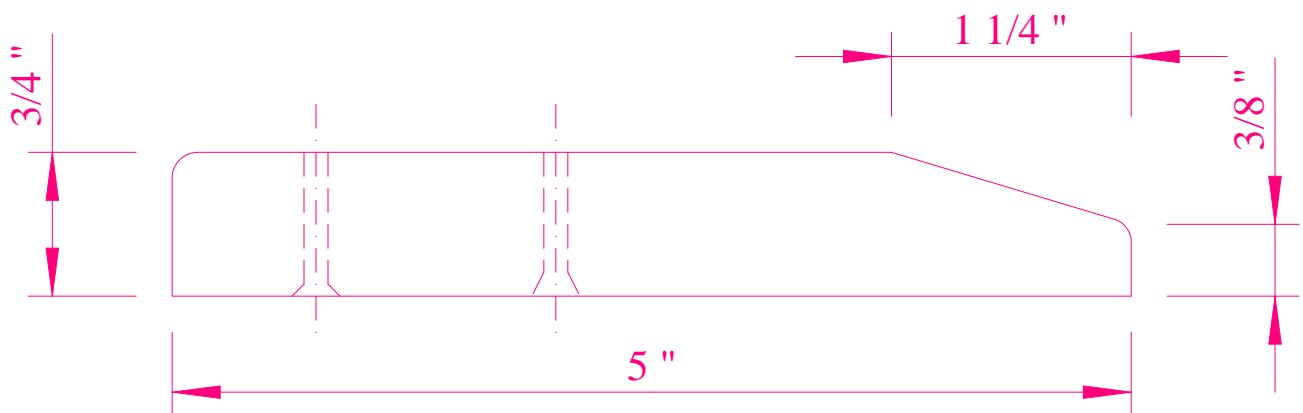
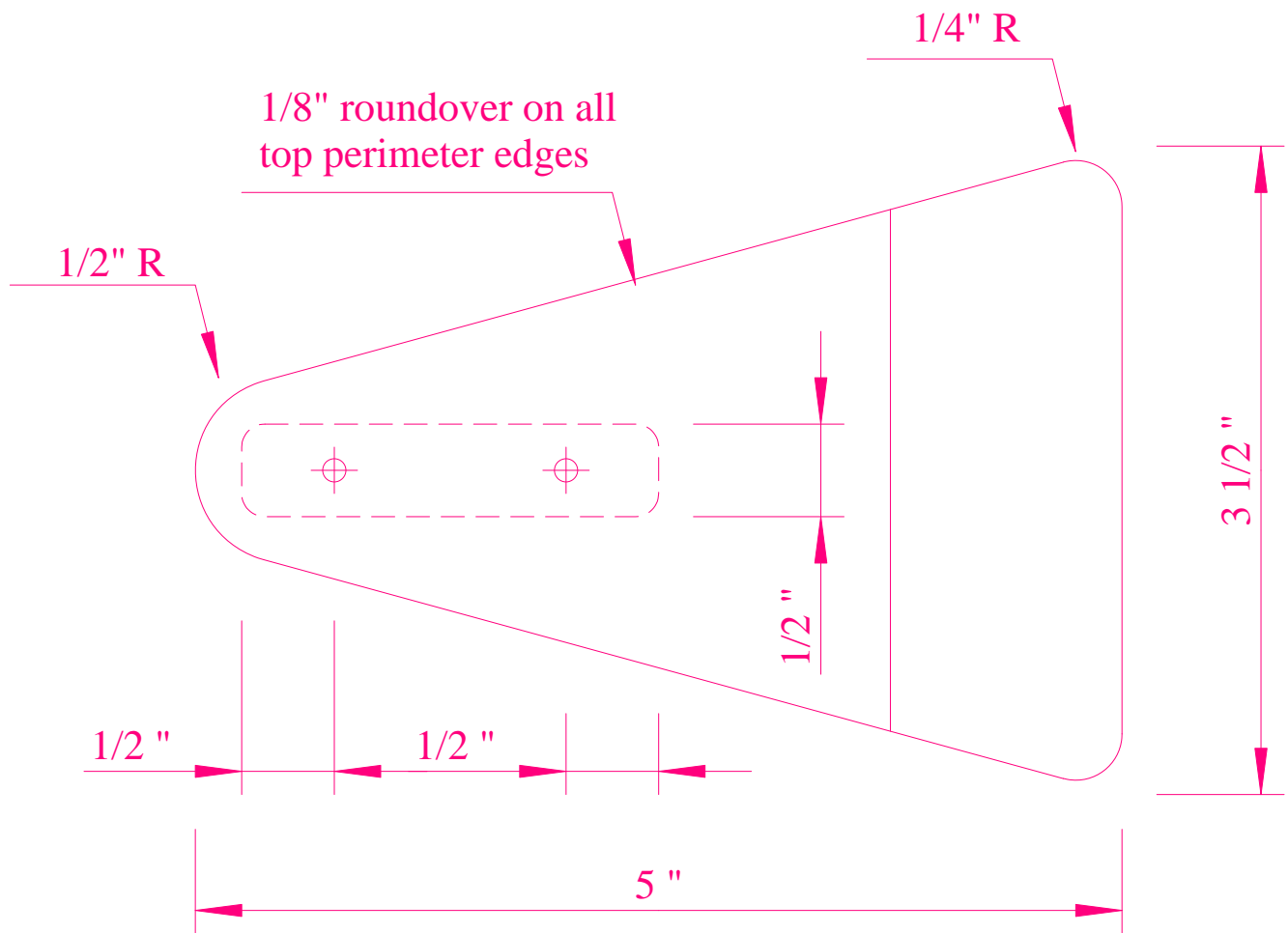

Base 1

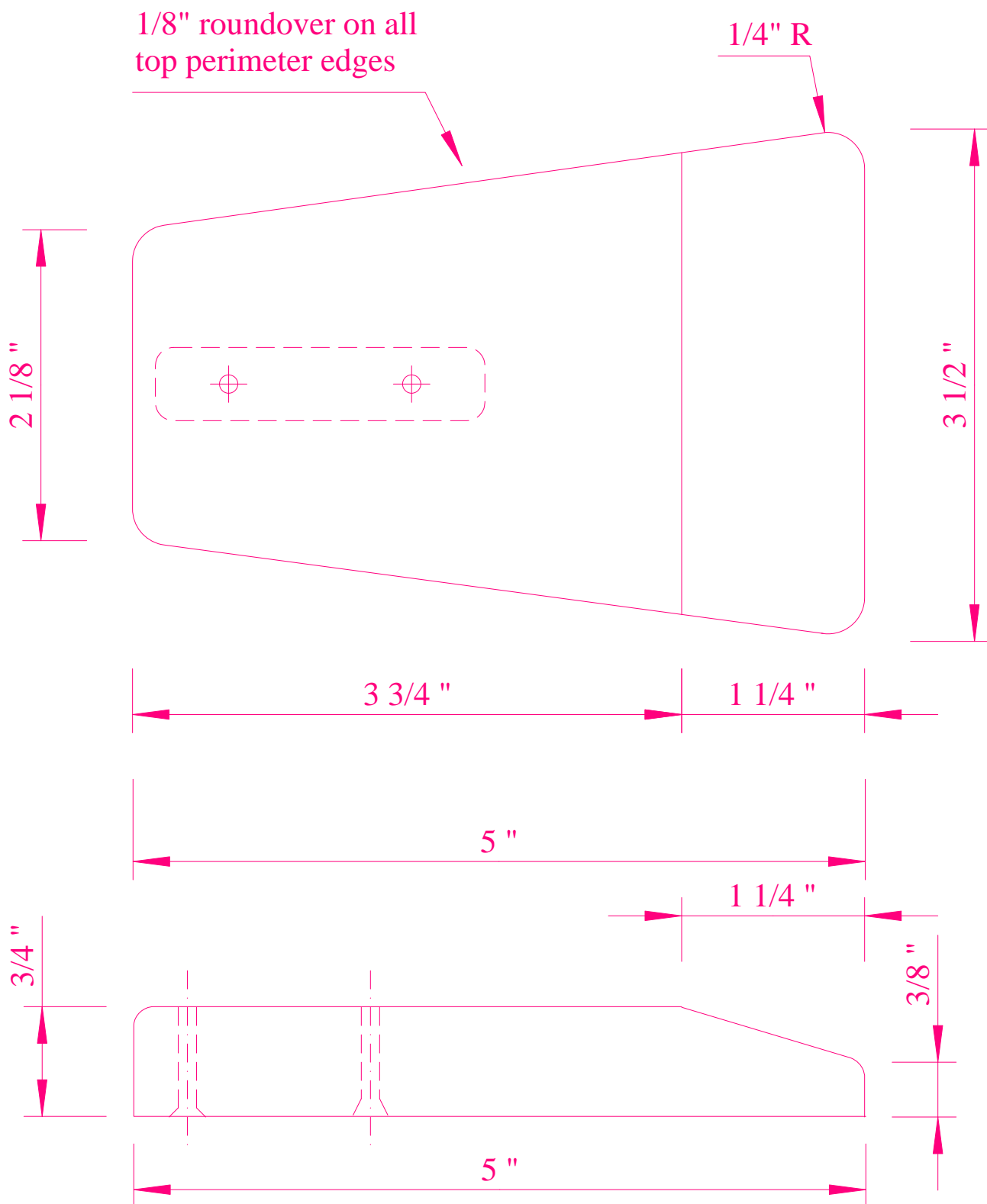

Base 2